

For collecting the vaporized solvents

Cold Trap Kit for Smart Evaporator C1

For the Smart Evaporator C1 operation, the trap is recommended for the case when the solvent collection is required. Since the evaporation with the Smart Evaporator involves the high speed airflow, this requires the different kind of the trap from the ones ordinary used with rotary evaporators. The wide hose is selected in this kit in order to minimize the airflow reduction which also reduces the pressure loss.



<u>Kit components</u>		
• Stand	-----	1pcs
• Condenser	-----	1pcs
• Muff	-----	2pcs
• Three prong clamp	-----	1pcs
• Cut ring	-----	1pcs
• Connecting hose	-----	3pcs
• Erlenmeyer Flask	-----	1pcs
• Hose nipple	-----	4pcs

■ Features

- The collecting ratio of solvents is 85%. (ex. Refrigerant : ice water. Solvent : Hexane)
- This closed system is ideal to prevent the impurity contamination.
- This system can also be installed to reduce the required amount of inert gas when the Smart Evaporator is preferred to be purged with the inert gas.

■ Important notices

- Never use liquid nitrogen for refrigerant. The oxygen may liquefy and explode.
- The components should be assembled as mentioned above since the recovery rate of solvent decreases if assembled in different ways.
- Operation of the Smart Evaporator requires an external vacuum source.

(The diaphragm vacuum pump is recommended.)

Component Size

Condenser + Erlenmeyer flask

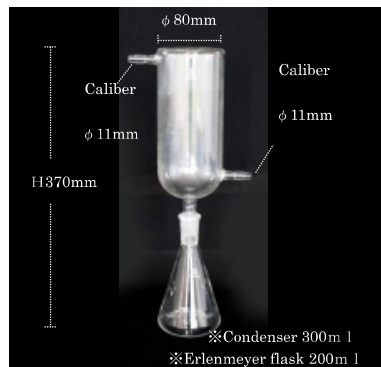

Stand

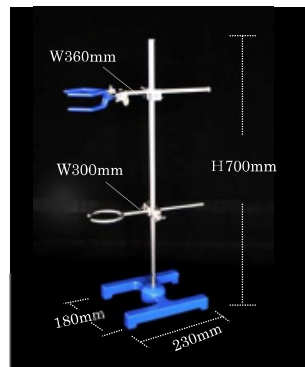

Setup Procedures

Setup configuration

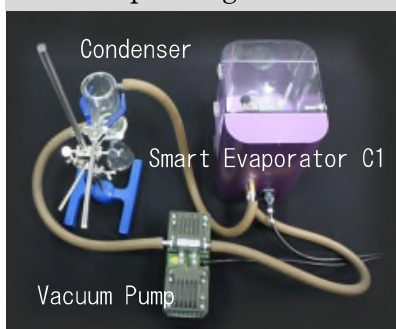

* Insert the hose nipples to the ports on the back of the Smart Evaporator C1 and inlet/exhaust ports of the vacuum pump.

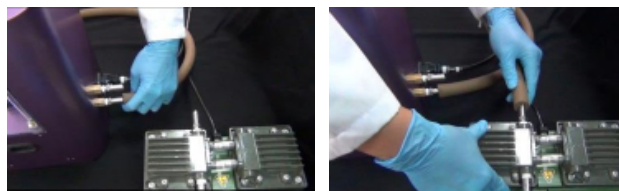

1. Connect the pump connection port on C1 (lower port) and the pump inlet port.



2. Connect the pump exhaust port and the connection port of the lower part of the condenser.

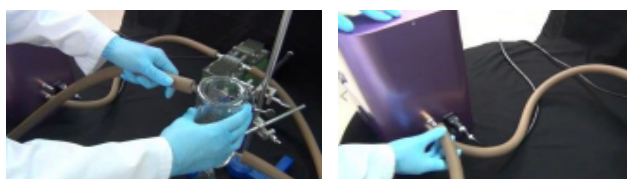

3. Connect the connection port on the top of the condenser and the circulation connection port on C1. (upper port)

Product Name	Cold Trap Kit for Smart Evaporator C1
Model Number	CIR-0A-00

No.01